

MATERIAL SCHEDULE			
ITEM No.	DESCRIPTION	QTY	DRN No.
P1	66 kV TRANSMISSION POLE	2	B17-10325
P2	SINGLE SUSPENSION CROSSARM ASSEMBLY	6	B20-11524
P3	SUSPENSION INSULATOR ASSEMBLY	6	B20-11542
P4	CONDUCTOR 30/7/3.5 ACSR/GZ "LIME"	6	EXISTING
P5	EARTH RISER EXTENSION PIECE ASSEMBLY	1	B20-11540
P6	OHEW SUSPENSION ASSEMBLY	1	B20-11544
P7	EARTH WIRE 19/2.0 SC/GZ	1	EXISTING

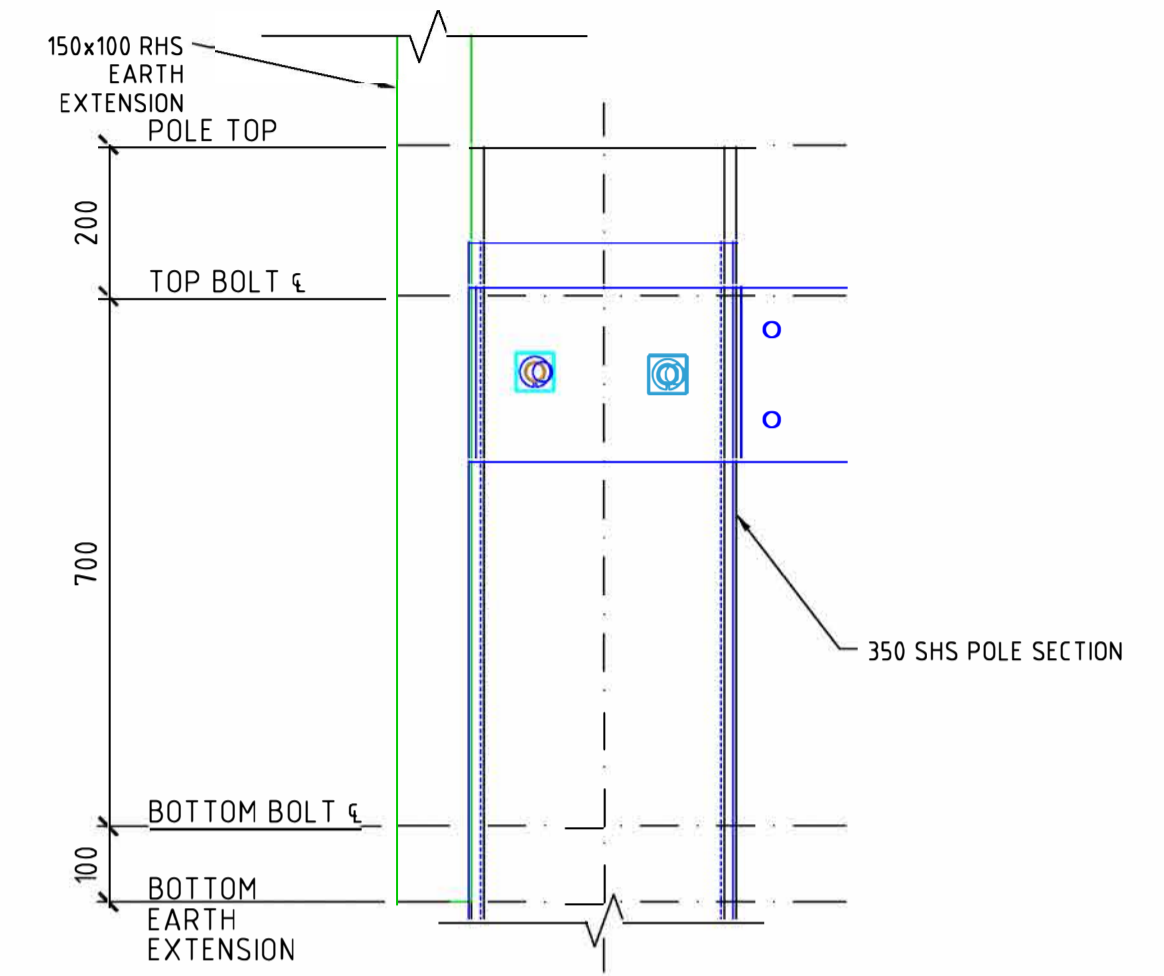

B DETAIL - DRILLING FOR E/W EXTN.
1:10

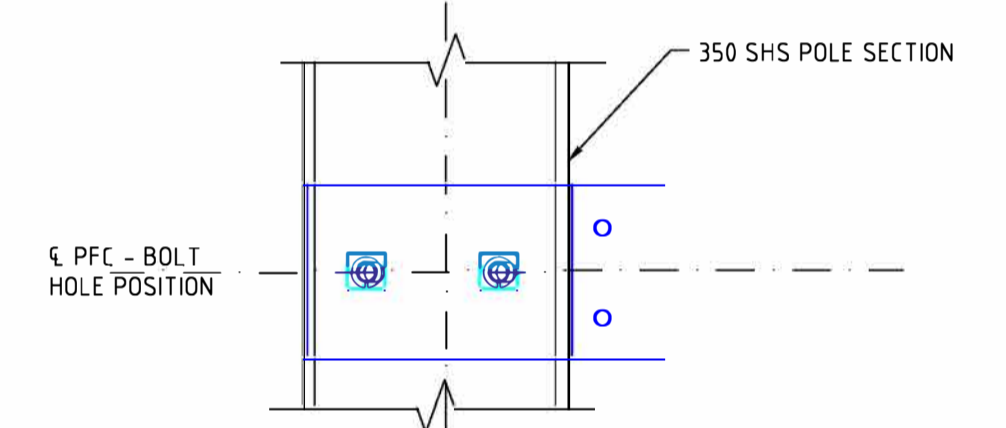

A DETAIL
1:10

- NOTES**
- SECTION PROFILES TO AS/NZS 3679.1. PLATE TO AS/NZS 3678.
 - ALL FABRICATION SHALL BE IN ACCORDANCE WITH AS 4100.
 - ALL BOLTS SHALL BE GRADE 8.8 CONFORMING TO AS/NZS 1252, COMPLETE WITH SINGLE OR DOUBLE NUTS (NOTED AS D NUTS), AND FLAT AND SPRING WASHER. FLAT WASHERS SHALL CONFORM TO AS/NZS 1252. SPRING WASHERS SHALL CONFORM TO AS/NZS 1559.
 - ALL WELDS SHALL BE IN ACCORDANCE WITH AS/NZS 1554.1-2011 6mm CFW CATEGORY SP U.N.O. E49 XX/W40XX ELECTRODE, WELDING INSPECTION SHALL BE 100% VISUAL.
 - HOLES ADJACENT TO BENDS SHALL BE FORMED AFTER BENDING.
 - EACH PIECE SHALL BE HARD-STAMPED WITH ITS IDENTIFYING ITEM NUMBER BEFORE GALVANISING. THE IDENTIFICATION MARK SHALL BE 12mm HIGH, PLACED TO BE CLEARLY VISIBLE AFTER GALVANISING. THE FORM OF THE IDENTIFICATION MARK SHALL BE "X#".
 - ALL ITEMS SHALL BE GALVANISED. STEEL PROFILES, PLATE AND WASHERS TO AS 4680, BOLTS AND NUTS TO AS1214.
 - ANY MATERIAL EXPOSED AFTER CUTTING OR DRILLING ON SITE SHALL BE PAINTED WITH TWO COATS OF ZINC RICH PAINT.
 - ALL DIMENSIONS IN MILLIMETRES (mm) U.N.O.
 - BOTTOM SECTION, 400 X 400 X 16 SHS PLUS 380PFC, APPROXIMATE WEIGHT 3230KG.
 - TOP SECTION, 350 X 350 X 12.5 SHS PLUS EARTH RISER PLUS 3 X CROSSARMS, APPROXIMATE WEIGHT 2120KG.

Example drawing 002 - SHS double circuit 66kV - June 2024

DRG NO	DESCRIPTION
	ASSOCIATED DRAWINGS

NO	AMENDMENTS	DRN	DATE	CKD	APPD



DES	Example drawing 002 - SHS double circuit 66kV - June 2024
DRN	
CKD	
APPD	
SCALE	AS SHOWN
ISSUED	
ALL DIM. IN mm	
DRAFTING STANDARD TO A.S.1100	

A1	DRAWING NUMBER D2024/247403 -
	CAD PRODUCT - DO NOT AMEND MANUALLY

