

TOP VIEW
SCALE (1 : 20)

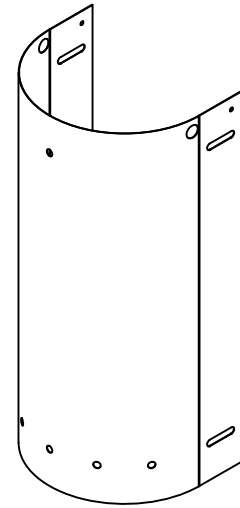

ISOMETRIC VIEW
SCALE (1 : 25)

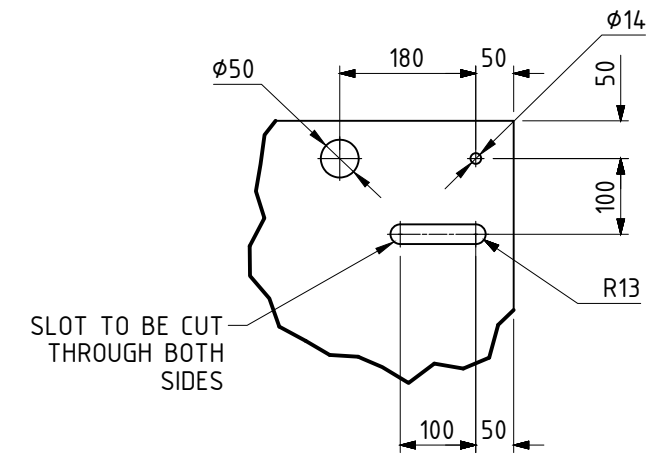

DETAIL A
SCALE (1 : 10)

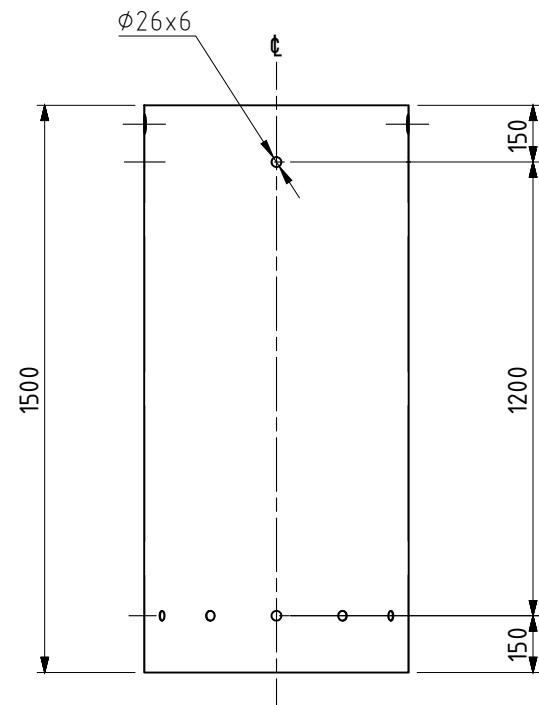

FRONT VIEW
SCALE (1 : 20)

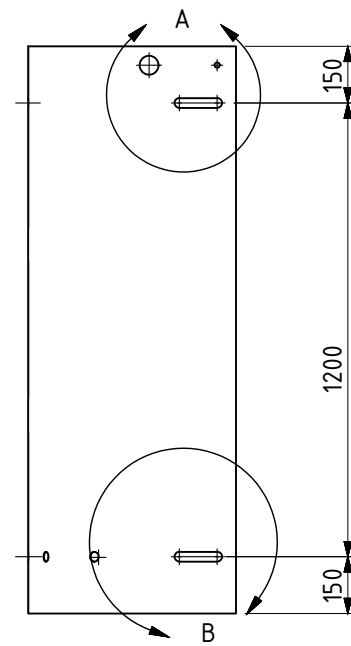

SIDE VIEW
SCALE (1 : 20)

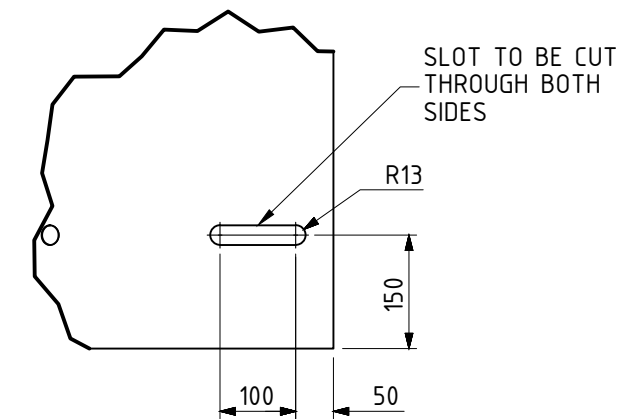

DETAIL B
SCALE (1 : 10)

ITEM NUMBER:505172
(ONE PAIR)

NOTES

1. TUBULAR ANTICLIMB DEVICE CONSISTS OF TWO HALVES DESIGNED TO OVERLAP AND FIT VARIOUS POLE DIMENSIONS. ITEM TO BE SUPPLIED AS ONE PAIR.
2. MATERIAL TO BE 2.0mm GALVANIZED SHEET STEEL.
3. FABRICATION AND GALVANIZING TO COMPLY WITH PWC STANDARD TECHNICAL SPECIFICATION STSP 01-002.
4. ALL ROUGH AND BURRED EDGES TO BE DRESSED CLEAN.

0	ISSUED FOR CONSTRUCTION	J.R.	FEB'25	B.V.	B.C.
NO	DESCRIPTION	DRN	DATE	CKD	APPD
AMENDMENTS					



DES	B.VANDERSTELT	POWER STANDARD DRAWING			
DRN	C.COPPINS	TUBE			
CKD	B.VANDERSTELT	ANTICLIMB DEVICE			
APPD	B.CHEUNG	GENERAL ARRANGEMENT			
SCALE	AS SHOWN				
ISSUED	MAY'23	A3	DRAWING NUMBER	S01-01-08-11	
ALL DIM.	IN mm				
DRAFTING STANDARD TO A.S.1100				AMDT	